

Filename: H:\2607\_ProposedGroundFloor\Drawings\CAD\Sheet\2607-KPF-MPLN-00-DR-PLN-A-0100.dwg Plotted by: Ascoglu, Belar Plot Time: 9/11/2019 4:03 PM

# Bermondsey Project

**Client**  
Southwark GP Nominee 1 Ltd. and  
Southwark GP Nominee 2 Ltd.



**Kohn Pedersen Fox Associates  
(International) PA**  
Architects and Planning Consultants  
7a Langley Street, London WC2H 9JA  
T: +44 (0) 20 3119 5300  
http://www.kpf.com

**Structural Engineer**  
WSP - Tel: 207 337 1700  
**MEP Engineer**  
Hilson Moran - Tel: 207 940 8888  
**Landscape Consultant (Strategy)**  
Arup - Tel: 207 636 1531  
**Landscape Consultant (Design)**  
Andy Sturgeon - Tel: 127 367 2575  
**Structural Engineer (Building F)**  
AKT II - Tel: 207 250 7777

## Key Plan

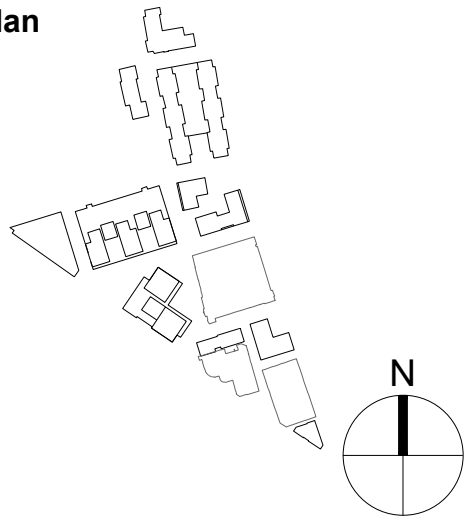

## Notes

NOTE: THE DETAILED DESIGN OF THE HARD AND SOFT  
LANDSCAPE IS SHOWN FOR ILLUSTRATIVE PURPOSES ONLY

OUTLINE COMPONENT

0 12.5M 25M 50M  
SCALE: 1:500

C	AMENDED PROPOSALS	16.09.19
B	ADDENDUM	04.06.18
A	ADDENDUM	19.01.18
W	WORKSHEET	DATE

Project  
2607 Bermondsey Project

Scale  
1:500 @ A0

Drawing Title and No.  
SITE GROUND FLOOR PLAN  
PROPOSED

Drawing Ref.  
2607-KPF-MPLN-00-DR-PLN-  
A-0100

Rev.  
C

© 2017 KOHN PEDERSEN FOX ASSOCIATES (INTERNATIONAL) PA. All rights reserved.  
Where drawing contains Ordnance Survey data © Crown Copyright Licence No. 10001984